

THE PLAN SHOWS THE
"VIJAYA MA-NAGAR"
 RESIDENTIAL LAYOUT AT R.S NO.89/4,
 89/6,109/7,109/2Apt,109/2Bpt,109/2C,111/1pt,
 111/2pt,111/3,111/4,111/6Bpt,112/2,112/3pt,
 113/2B, 113/2Cpt,113/2D/1pt,114/2,114/3,
 114/6,115/1A,115/1B,115/3B,
 POORNANKUPPAM REVENUE VILLAGE,
 ARIYANKUPPAM COMMUNE
 PANCHAYATE, PUDUCHEERY.

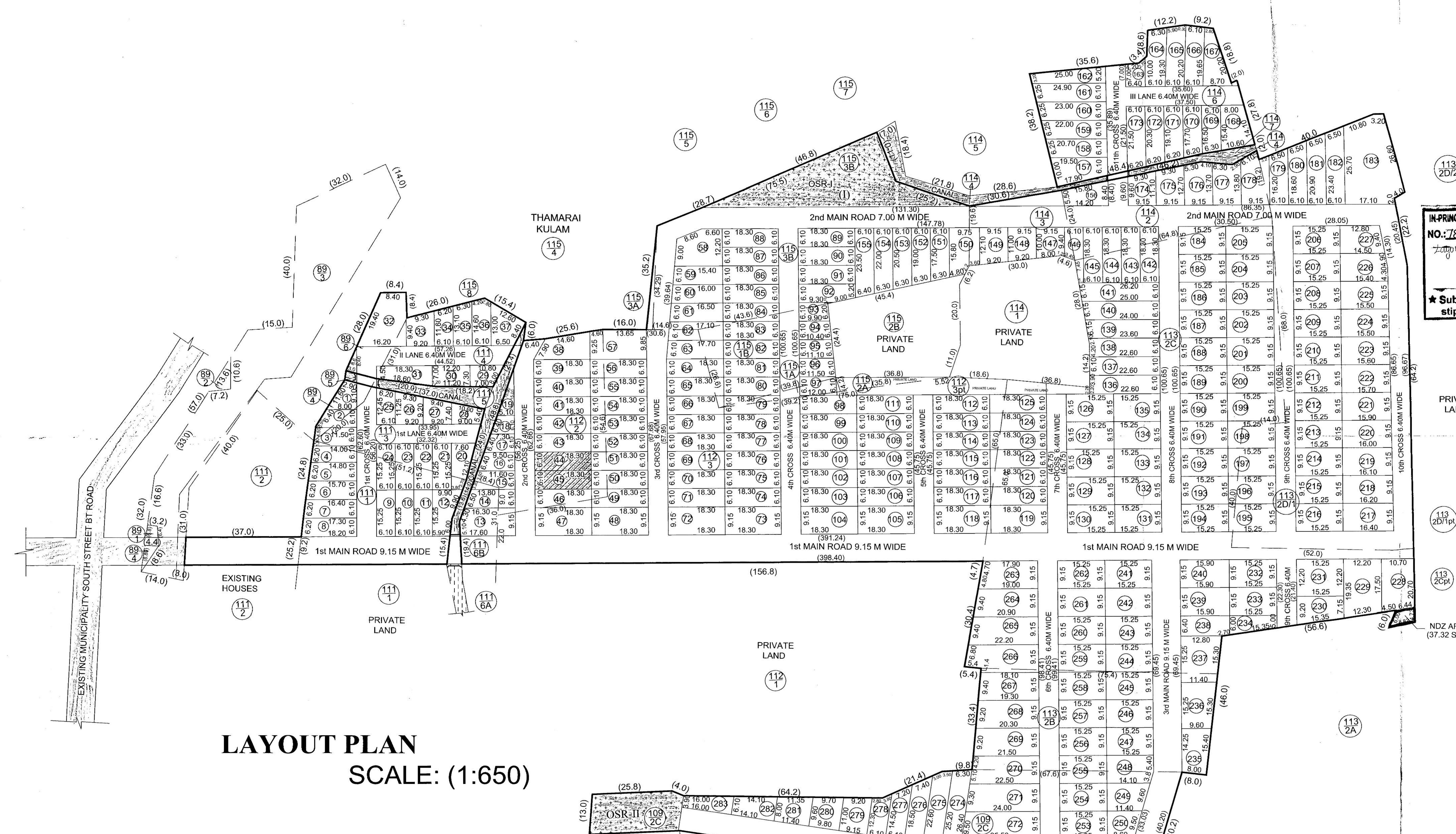
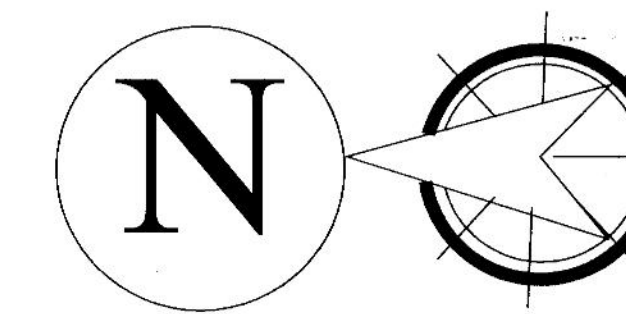

IN-PRINCIPLE LAYOUT FRAME WORK APPROVAL ISSUED WIDE
 NO: 788/136/199/2019 DATED: 4 FEB 2019
 PUDUCHERRY PLANNING AUTHORITY
 MEMBER SECRETARY
 * Subject to the fulfilment of conditions stipulated in the permit (Sl.No. 1 to 9)

Total Layout Area	53262.00 Sq.m	100.00 %
Total Sold Plot Area	222.96 Sq.m	0.42 %
Total Un Sold Plot Area	34828.15 Sq.m	65.39 %
Total Road Area	14663.80 sq.m	27.53 %
Proposal O.S.R -I,II,III & NDZ Area	3547.09 Sq.m	6.65 %

OWNER
 1. K. S. ... 2. C. ... 3. J. ...
 4. ... 5. ... 6. ...
REGISTERED TOWN PLANNER

R. KARUNAMOORTHY, AMIE, M.Tech.,
 ATTORNEY-AT-LAW, PRACTISING
 REGISTERED TOWN PLANNER
 (No. 47, First Cross, Valluvar Nagar,
 Kambajur Salai, Keralai - 605 002)

LEGEND

PLOT	[Symbol]
SOLD PLOT	[Symbol]
UN SOLD PLOT	[Symbol]
OSR	[Symbol]
CHANNEL	[Symbol]
BOUNDARY LINE	[Symbol]

SCALE: (1:650)
 ALL DIMENSIONS ARE IN "METRE"
 (UNLESS OTHERWISE MENTIONED)

LAYOUT PLAN
 SCALE: (1:650)

SOLD PLOT AREA DETAILS

Plot No	Extent Sq.M
44	111.48
45	111.48
TOTAL	222.96

O.S.R DETAILS

SL.No	DESCRIPTION	Area in Sq. M
1	O.S.R AREA-I	846.35
2	O.S.R AREA-II	413.42
3	O.S.R AREA-III	2250.00
4	N.D.Z AREA	37.32
TOTAL	3547.09	

UN SOLD PLOT AREA DETAILS

Plot No	Extent Sq.M	Plot No	Extent Sq.M	Plot No	Extent Sq.M	Plot No	Extent Sq.M	Plot No	Extent Sq.M	Plot No	Extent Sq.M
1	56.41	43	111.48	87	111.48	129	139.35	171	112.24	213	139.35
2	59.47	46	111.48	88	111.48	130	139.35	172	120.17	214	139.35
3	77.77	47	167.22	89	111.48	131	139.35	173	127.49	215	139.35
4	87.84	48	167.22	90	111.48	132	139.35	174	94.70	216	139.35
5	93.02	49	111.48	91	111.48	133	139.35	175	108.89	217	149.14
6	97.90	50	111.48	92	112.53	134	139.35	176	120.78	218	147.77
7	102.75	51	111.48	93	58.56	135	139.35	177	125.81	219	146.85
8	108.27	52	111.48	94	61.91	136	137.86	178	137.25	220	145.94
9	92.90	53	111.48	95	65.57	137	137.86	179	106.14	221	144.57
10	92.90	54	111.48	96	68.93	138	140.91	180	120.47	222	143.20
11	92.90	55	111.48	97	71.67	139	145.18	181	135.11	223	142.28
12	120.47	56	111.48	98	111.48	140	149.45	182	149.76	224	141.82
13	155.09	57	174.52	99	111.48	141	156.16	183	458.93	225	141.36
14	91.80	58	169.56	100	111.48	142	111.48	184	139.35	226	136.79
15	77.47	59	95.77	101	111.48	143	111.48	185	139.35	227	124.90
16	64.36	60	99.13	102	111.48	144	111.48	186	139.35	228	148.52
17	51.24	61	102.48	103	111.48	145	111.48	187	139.35	229	224.79
18	37.82	62	106.14	104	167.22	146	78.52	188	139.35	230	124.67
19	38.25	63	109.80	105	167.22	147	88.75	189	139.35	231	185.80
20	86.92	64	111.48	106	111.48	148	96.07	190	139.35	232	139.35
21	92.90	65	111.48	107	111.48	149	105.68	191	139.35	233	139.35
22	92.90	66	111.48	108	111.48	150	137.25	192	139.35	234	83.87
23	92.90	67	111.48	109	111.48	151	101.57	193	139.35	235	130.46
24	92.90	68	111.48	110	111.48	152	111.33	194	139.35	236	160.12
25	72.28	69	111.48	111	111.48	153	120.48	195	139.35	237	184.52
26	94.07	70	111.48	112	111.48	154	129.63	196	139.35	238	98.33
27	76.36	71	111.48	113	111.48	155	138.78	197	139.35	239	145.48
28	60.77	72	167.22	114	111.48	156	103.20	198	139.35	240	145.48
29	68.09	73	167.22	115	111.48	157	149.32	199	139.35	241	139.35
30	87.23	74	111.48	116	111.48	158	122.61	200	139.35	242	139.35
31	105.23	75	111.48	117	111.48	159	130.23	201	139.35	243	139.35
32	218.94	76	111.48	118	167.22	160	137.25	202	139.35	244	139.35
33	96.60	77	111.48	119	167.22	161	146.09	203	139.35	245	139.35
34	75.34	78	111.48	120	111.48	162	104.58	204	139.35	246	139.35
35	84.48	79	111.48	121	111.48	163	48.10	205	139.35	247	139.35
36	90.47	80	111.48	122	111.48	164	115.60	206	139.35	248	137.38
37	97.37	81	111.48	123	111.48	165	120.48	207	139.35	249	116.66
38	134.32	82	111.48	124	111.48	166	121.54	208	139.35	250	91.50
39	111.48	83	111.48	125	111.48	167	111.68	209	139.35	251	121.58
40	111.48	84	111.48	126	139.35	168	129.80	210	139.35	252	90.30
41	111.48	85	111.48	127	139.35	169	97.30	211	139.35	253	139.35
42	111.48	86	111.48	128	139.35	170	104.31	212	139.35	254	139.35
TOTAL	34828.15										

LAND AREA DETAILS

Sl.No	RS.No	PURCHASE AREA H.A.Ca	LAYOUT AREA H.A.Ca	Sq.M
1	89/4	00.01.12	00.01.12	112
2	89/6	00.02.82	00.02.82	282
3	109/7	00.22.50	00.22.50	2250
4	109/2A	00.02.61	00.02.61	261
5	109/2B	00.02.99	00.02.99	299
6	109/2C	00.46.50	00.46.50	4650
7	111/1	00.18.00	00.18.00	1800
8	111/2	00.04.01	00.03.46	346
9	111/3	00.09.50	00.09.50	950
10	111/4	00.09.50	00.09.50	950
11	111/6B	00.03.25	00.02.59	259
12	112/2	00.20.00	00.20.00	2000
13	112/3	00.94.00	00.81.75	8175
14	113/2B	00.27.00	00.27.00	2700
15	113/2C	01.45.19	01.20.32	12032
16	113/2D/1	00.78.00	00.64.31	6431
17	114/2	00.14.65	00.14.65	1465
18	114/3	00.06.50	00.06.50	650
19	114/6	00.25.00	00.25.00	2500
20	115/1A	00.00.83	00.00.83	83.00
21	115/1B	00.10.17	00.10.17	1017
22	115/3B	00.40.50	00.40.50	4050
TOTAL	05.84.64	05.32.62	53262	

ROAD AREA DETAILS

ROAD	Dimension	Area in Sq. m
1st Main Road	395.40x9.15	3617.91
2nd Main Road	170.38x7.00	1192.69
3rd Main Road	190.95x9.15	1746.26
4th Main Road	170.45x9.15	1559.69
1st Cross Road	62.60x6.40	400.64
2nd Cross Road	68.46x6.40	438.16
3rd Cross Road	65.60x6.40	419.84
4th Cross Road	100.65x6.40	644.16
5th Cross Road	45.75x6.40	292.80
6th Cross Road	106.21x6.40	679.76
7th Cross Road	45.75x6.40	292.80
8th Cross Road	108.46x6.40	694.16
9th Cross Road	114.91x6.40	735.45
10th Cross Road	125.22x6.40	801.44
11th Cross Road	52.61x6.40	336.72
1st Lane Road	33.60x6.40	215.04
2nd Lane Road	55.67x6.40	356.28
3rd Lane Road	37.50x6.40	240.00
TOTAL	14663.80	

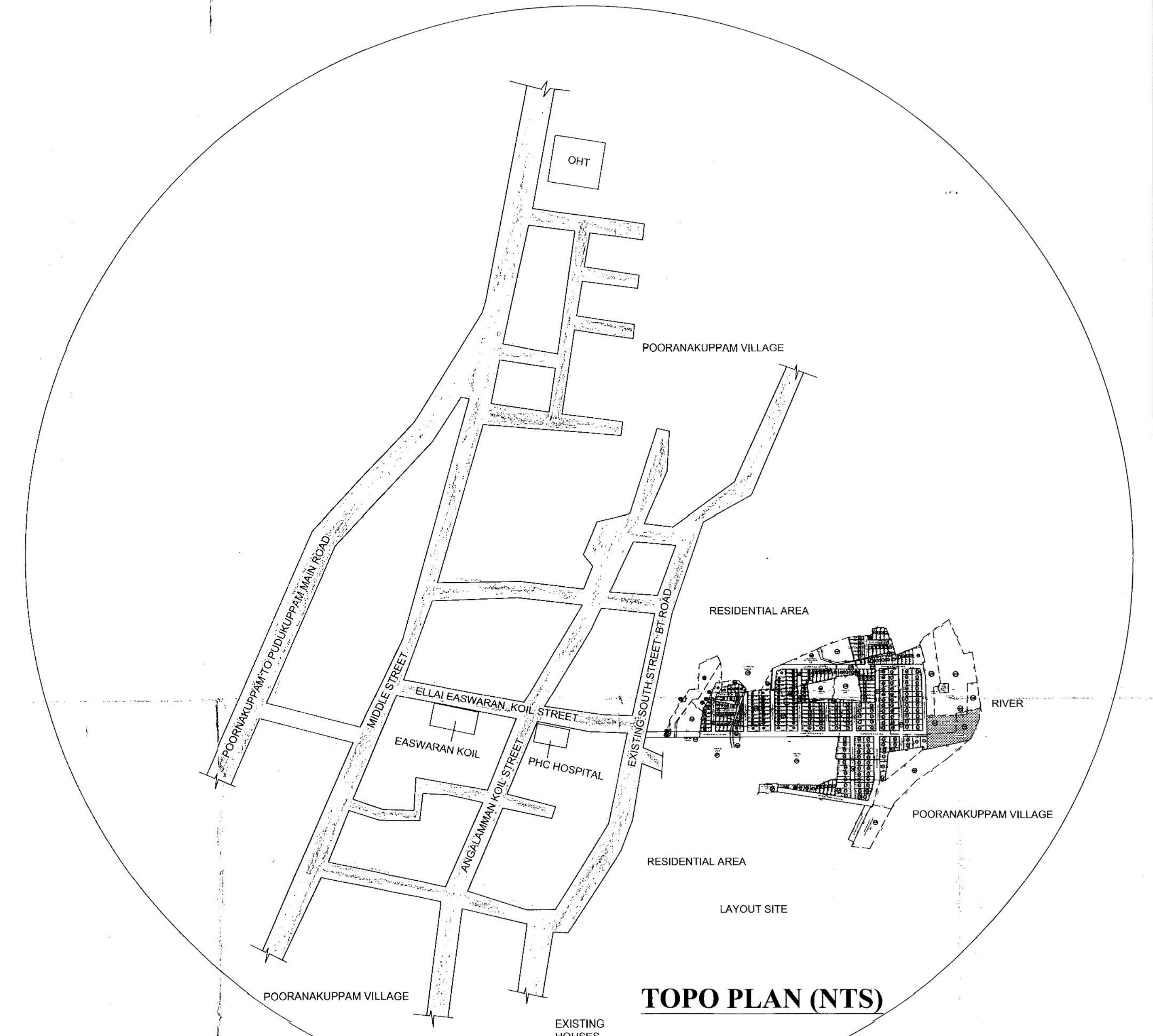

TOPO PLAN (NTS)