

EXISTING RESIDENTIAL LAYOUT
"MULLAI NAGAR" AT R.S.NO.75/2Bpt,
75/6, 75/7, 75/9B, 75/9C, 75/10, KORKADU,
KORKADU REVENUE VILLAGE,
NETTAPAKKAM COMMUNE, PUDUCHERRY.

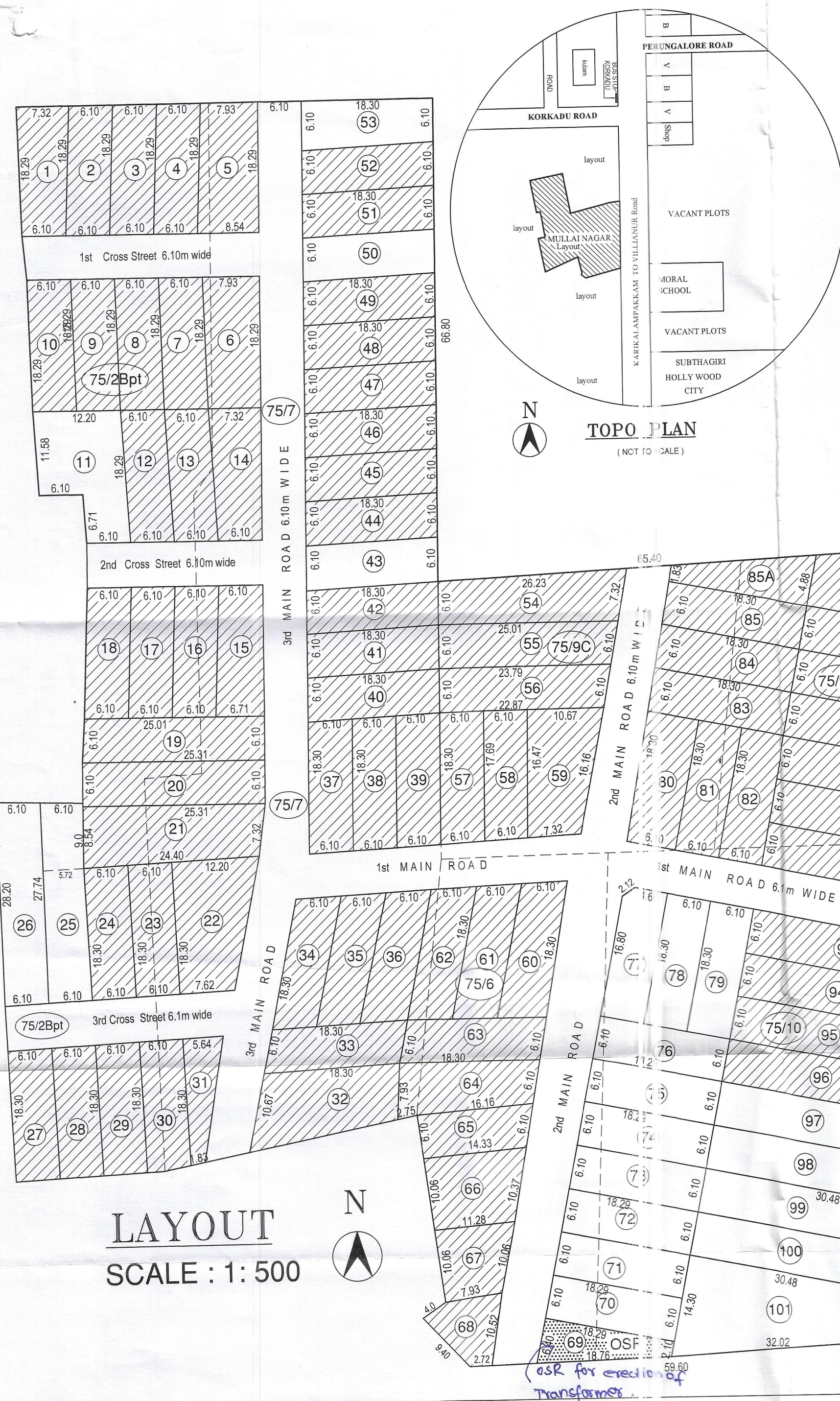

SOLD PLOTS - 80 Nos

Plot Nos.	No.of Plots	Area in Sq.m	Total Area in Sq.m	Plot Nos.	No.of Plots	Area in Sq.m	Total Area in Sq.m
1	1	122.68	122.68	51 & 52	2	111.52	223.04
2 to 4	3	111.52	334.56	54	1	171.75	171.75
5	1	150.56	150.56	55	1	148.70	148.70
6	1	139.41	139.41	56	1	142.19	142.19
7 to 10	4	111.52	446.08	57	1	109.67	109.67
12 & 13	2	111.52	223.04	58	1	104.09	104.09
14	1	122.68	122.68	59	1	146.65	146.65
15	1	117.10	117.10	60 to 63	4	111.52	446.08
16 to 18	3	111.52	334.56	64	1	128.25	128.25
19	1	153.35	153.35	65	1	92.94	92.94
20	1	154.28	154.28	66	1	130.76	130.76
21	1	196.93	196.93	67	1	96.56	96.56
22	1	181.23	181.23	68	1	76.67	76.67
23 & 24	2	111.52	223.04	80 to 85	6	111.52	669.12
27 to 30	4	111.52	446.08	85A	1	61.34	61.34
31	1	69.42	69.42	86	1	217.46	217.46
32	1	170.07	170.07	87 to 96	10	185.72	1857.27
33 to 42	10	111.52	1115.20				
44 to 49	6	111.52	669.12				
				Total			10191.93

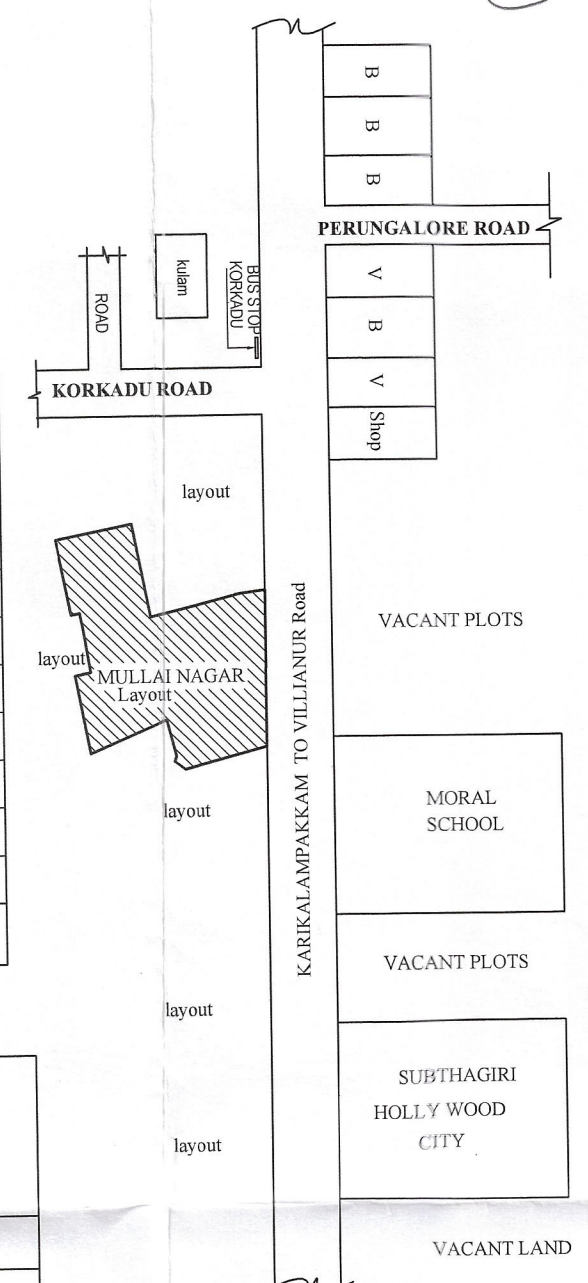

Total Road & O.S.R Area hand over to Nettapakkam Commune Panchayat as per Document No. 0463/22

ROAD	Area in Sq.m
1st Main Road	622.17
2nd Main Road	653.49
3rd Main Road	859.48
1st Cross Street	199.07
2nd Cross Street	148.84
3rd Cross Street	189.29
Total Road Area	2672.34
O.S.R (Plot No.69)	77.74 sq.m
Grand Total (Road Area + O.S.R)	2750.08 sq.m

UNSOLD PLOTS - 22 Nos

Plot Nos.	No.of Plots	Area in Sq.m	Total Area in Sq.m
11	1	131.40	181.40
25	1	162.08	162.64
26	1	170.62	170.62
43	1	111.52	111.52
50	1	111.52	111.52
53	1	111.52	111.52
70 to 76	7	111.52	780.64
77	1	110.39	110.39
78 & 79	2	111.52	223.04
97 to 100	4	185.87	743.48
101	1	315.36	315.36
Total			3033.99

AREA AS PER DOCUMENT

R.S.No.	Ka - Ku - Ve	H - A - CA	Area in Sq.m
75/7	00 - 93 - 13	00 - 50 - 20	5020.00
75/2Bpt	00 - 57 - 06	00 - 30 - 70	3070.00
75/10	00 - 45 - 1/2	00 - 24 - 09	2409.00
75/10	00 - 15 - 00	00 - 08 - 05	805.00
75/9B	00 - 28 - 10	00 - 15 - 34	1534.00
75/9C	00 - 28 - 10	00 - 15 - 33	1533.00
75/6	00 - 30 - 00	00 - 16 - 05	1605.00
Total area			15976.00

TOTAL AREA : 15976.00 Sq.m

SOLD PLOTS AREA : 10191.93 Sq.m

UNSOLD PLOTS AREA : 3033.99 Sq.m

ROAD AREA : 2672.34 Sq.m

OSR AREA : 77.74 Sq.m (PLOT NO.69)

All Dimensions are in "Meter" SCALE : 1: 500

Owner

- [Signature]*
- T. [Signature]
- A. [Signature]

Engineer **R. Sasikala**
R. SASIKALA, D.Arch.,
LICENSED SUPERVISOR
 Reg. No: 3-532/PPA/LIC/2004
 #2, 1st Floor, Mangane Street,
 (Next to Sri Kumaran Stores)
 Reddiarpalayam,
 Pudukcherry - 605 005.
 Cell: 9865265643

Approving Authority

IN-PRINCIPLE LAYOUT FRAME WORK APPROVAL ISSUED VIDE
 NO. PPA/2023/2922/PPA/DATE 26 MAY 2023
 Z(NCP/Layout/IP-APP)/2019-23.
[Signature]
 MEMBER SECRETARY
PUDUCHERRY PLANNING AUTHORITY
 *Subject to the fulfilment of conditions
 Stipulated in the permit (Sl. No.1 to)

10/10 9/6 2/2
 24/18