

Proposed Layout of BEST AVENUE

RS.No. 14/2 Part
KADUVANUR REVENUE VILLAGE,
KADUVANUR, BAHOUR COMMUNE,
PUDUCHERRY.

IN-PRINCIPLE LAYOUT FRAME WORK APPROVAL ISSUED VIDE
NO.: 598/3801/PPA DATED: 28 JAN 2020
2(BCP/IP-Unapproved)/2020
MEMBER SECRETARY
PUDUCHERRY PLANNING AUTHORITY
* Subject to the fulfilment of conditions stipulated in the permit (S.No. 1 to 10)

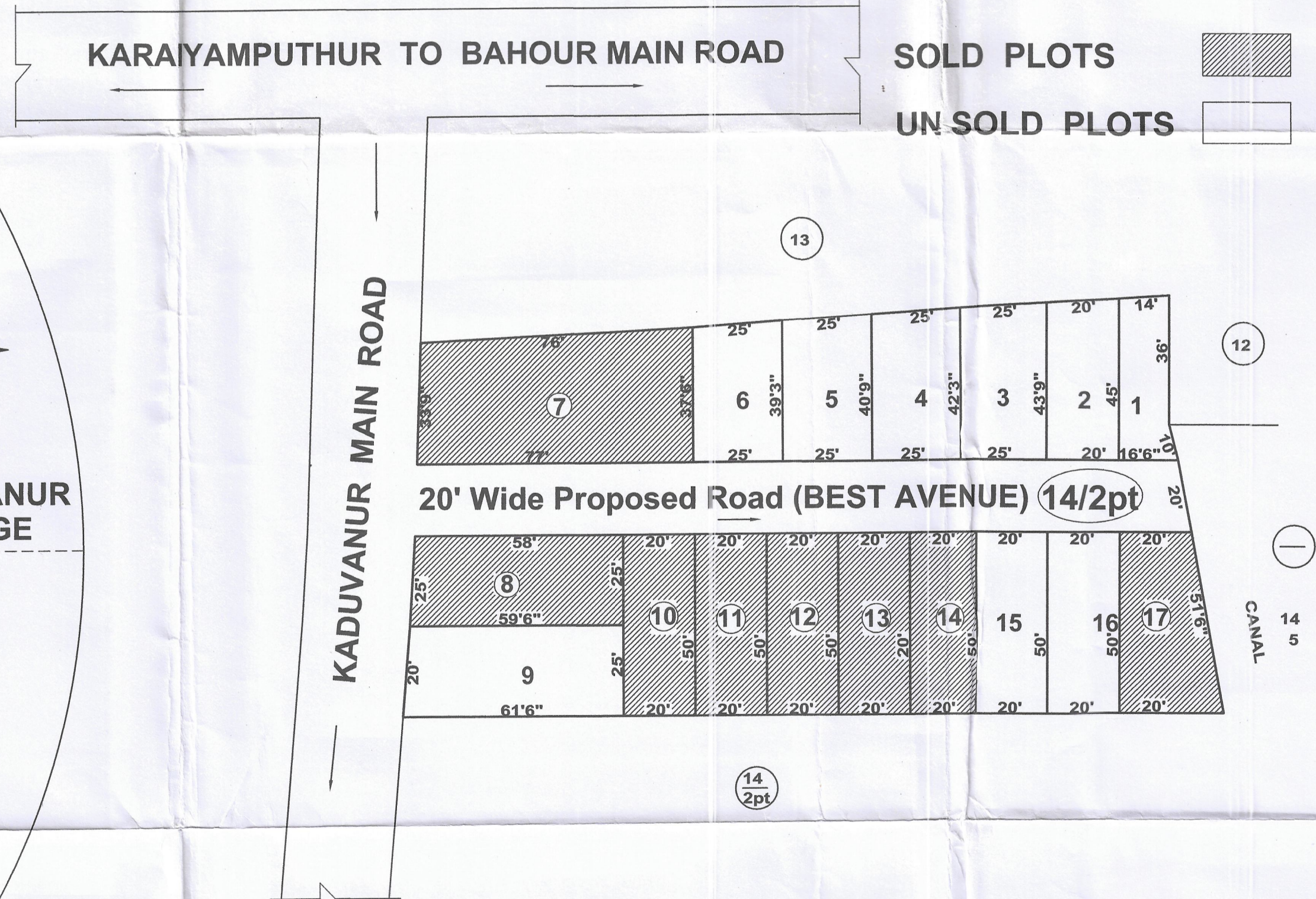
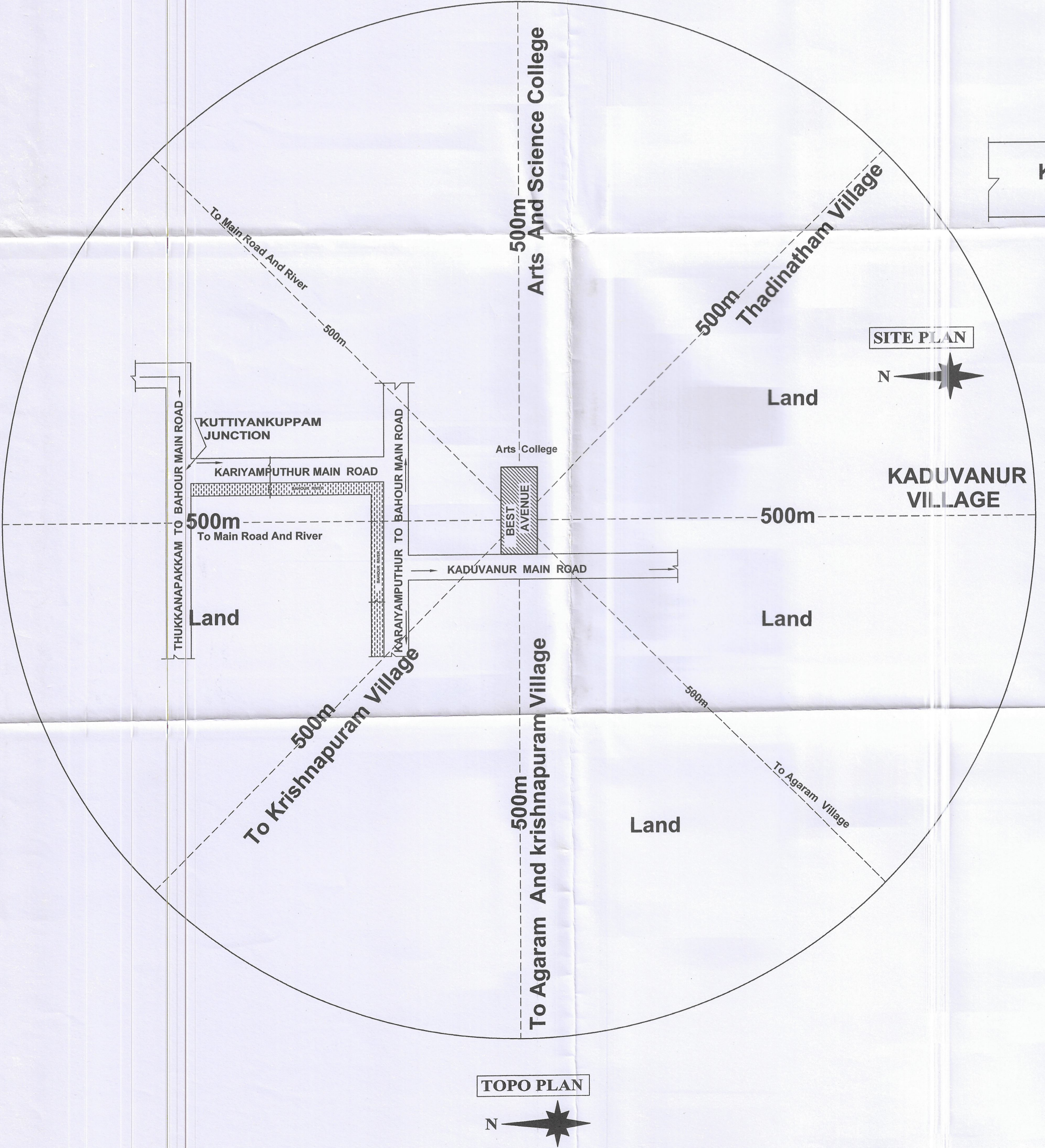

R.S.No : 14/2 Part

Area	Sqft	Sqm
Total Area	23878	2218.40
Plot Area	19562	1817.38
Sold Plots	10422	968.22
Un Sold Plots	9140	849.16
Road Portion	4316	401.02
OSR Area	Nil	

R.S.No : 14/2 Part

Plot No.	Area Sq.ft	Plot No.	Area Sq.ft	Plot No.	Area Sq.ft
1	706	7	2725	13	1000
2	886	8	1468	14	1000
3	1075	9	1512	15	1000
4	1037	10	1000	16	1000
5	962	11	1000	17	1225
6	959	12	1000		

R.S.No : 14/2 Part

SOLD PLOTS		UN SOLD PLOTS	
Plot No.	Area Sq.ft	Plot No.	Area Sq.ft
7	2725	1	706
8	1468	2	886
10	1000	3	1075
11	1000	4	1037
12	1000	5	962
13	1000	6	959
14	1000	9	1512
17	1225	15	1000
		16	1000

Owner :
H. S. S. S. S. S.

Engineer :
R. Palanidoss
Er. R. PALANIDOSS, B.E (CIVIL)
Reg No: 685/P/PA/RE/2010
JAYAM BUILDERS
1st Floor, Muthalman Koil Street
Villanur Main Road, Pavazha Nagar
Puducherry - 605 005.
Mobile: 96774 21742, 96774 34764