

# PLAN SHOWS THE LAYOUT IN THE NAME OF "ARUNACHALAM NAGAR" AT R.S.No. 5/8Apt., 6/1 & 6/2.,

## ODIAMPET REVENUE VILLAGE, VILLIANUR COMMUNE PANCHAYAT, PUDUCHERRY.

N

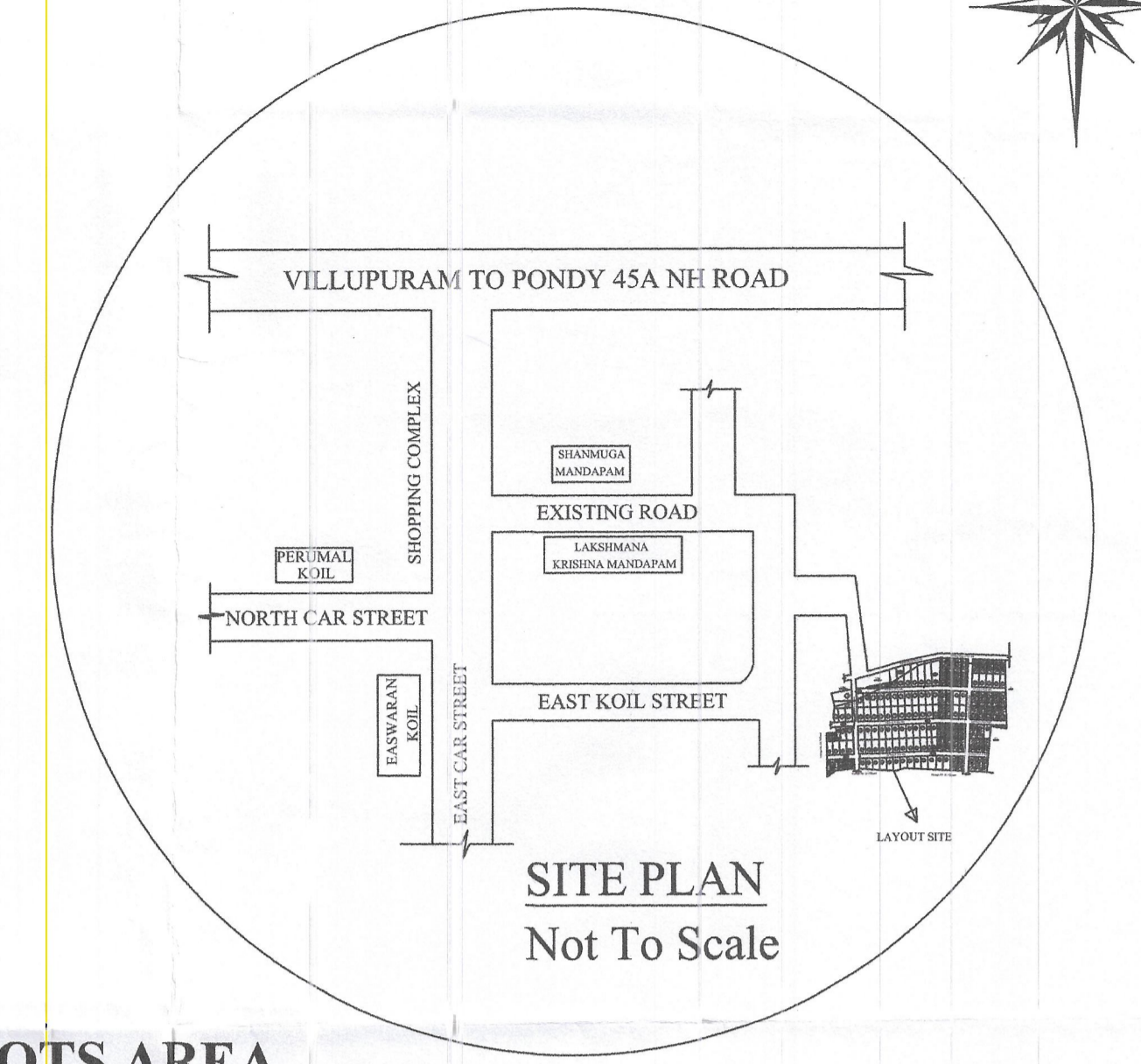
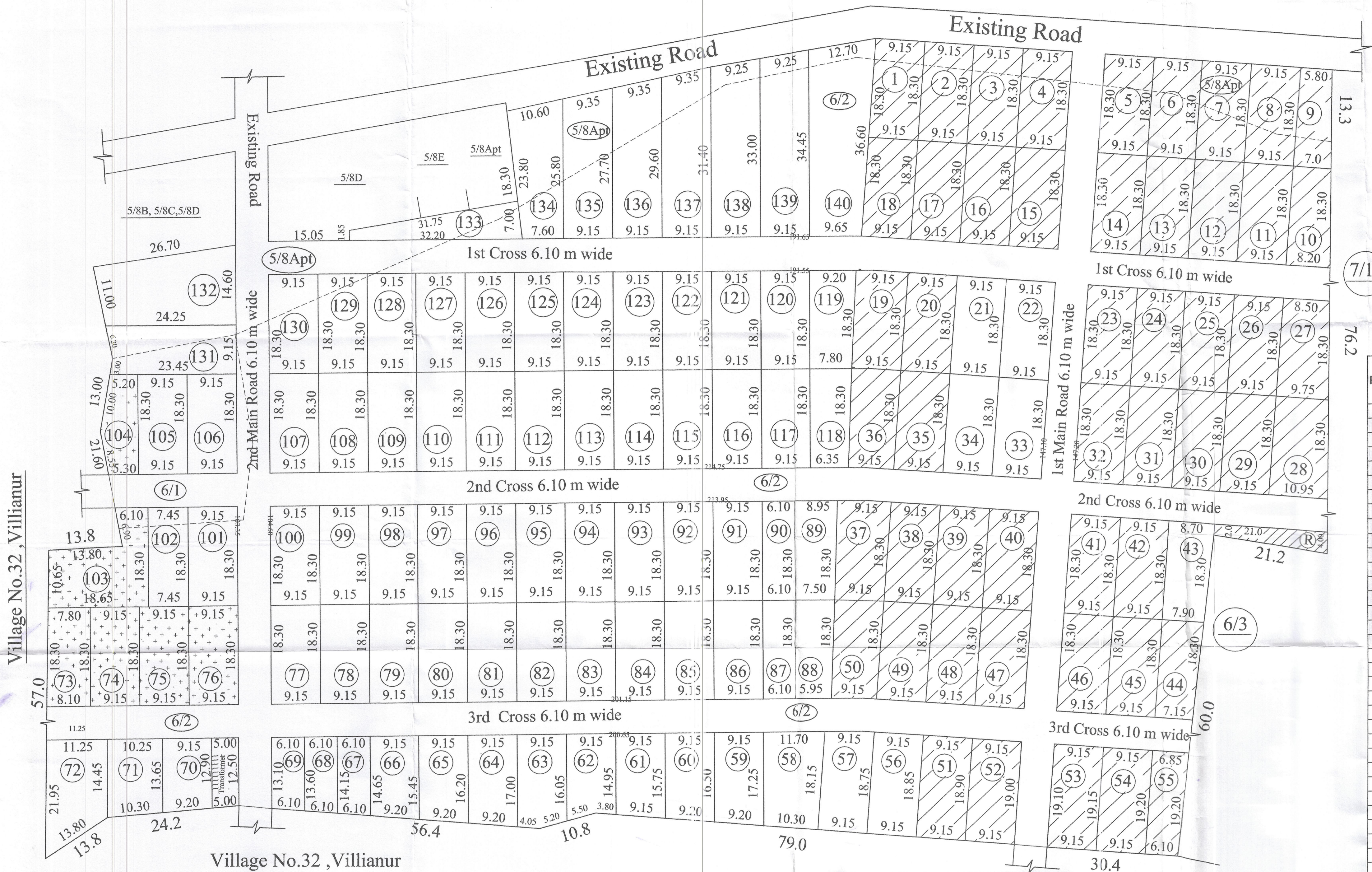
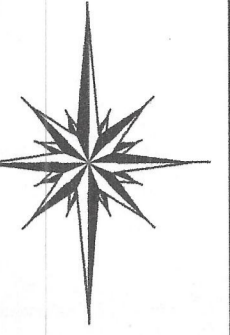

### UNSOLD PLOTS AREA

Plot Number	No.	Each Area (m <sup>2</sup> )	Area (m <sup>2</sup> )
21 and 22	2	167.44	334.88
33 and 34	2	167.44	334.88
43	1	151.89	151.89
56	1	172.02	172.02
57	1	168.81	168.81
58	1	194.70	194.70
59	1	154.40	154.40
60	1	147.50	147.50
61	1	140.45	140.45
62	1	138.30	138.30
63	1	154.60	154.60
64	1	151.90	151.90
65	1	144.80	144.80
66	1	137.70	137.70
67	1	87.84	87.84
68	1	84.64	84.64
69	1	81.44	81.44
70	1	121.73	121.73
71	1	144.36	144.36
72	1	227.95	227.95
77 to 86	10	167.44	1674.40
87	1	111.63	111.63
88	1	123.00	123.00
89	1	150.51	150.51
90	1	111.63	111.63
91 to 101	11	167.44	1841.84
102	1	138.33	138.33
105 to 117	13	167.44	2176.72
118	1	129.47	129.47
119	1	155.55	155.55
120 to 130	11	167.44	1841.84
131	1	213.00	213.00
133	1	121.11	121.11
132	1	322.50	322.50
134	1	224.00	224.00
135	1	244.76	244.76
136	1	262.14	262.14
137	1	279.07	279.07
138	1	294.63	294.63
139	1	308.58	308.58
140	1	391.50	391.50
<b>Total</b>	<b>84</b>		<b>14388.99</b>

Area Details	Area (m <sup>2</sup> )
LAYOUT AREA	29020.00
SOLD PLOTS AREA	8330.24
UNSOLD PLOTS AREA	14388.99
ROAD PORTION AREA	5233.66
TRANSFORMER AREA	63.50
OSR PROVIDED	1003.61
OSR REQUIRED (10%)	1438.90
OSR STILL REQUIRED	371.79

### SOLD PLOTS AREA

Plot Number	No.	Each Area (m <sup>2</sup> )	Area (m <sup>2</sup> )
1 to 8	8	167.44	1339.52
9	1	117.10	117.10
10	1	139.40	139.40
11 to 20	10	167.44	1674.40
23 to 27	5	167.44	837.20
28	1	189.60	189.60
29 to 32	4	167.44	669.76
35 to 42	8	167.44	1339.52
R	1	60.00	60.00
44	1	138.00	138.00
45 to 50	6	167.44	1004.64
51 to 54	4	174.30	697.20
55	1	123.90	123.90
<b>Total</b>	<b>51</b>		<b>8330.24</b>

**IN-PRINCIPLE LAYOUT FRAME WORK APPROVAL ISSUED VIDE NO. 588/2353/PPA DATED 1 MAR 2022**  
 MEMBER SECRETARY  
**PUDUCHERRY PLANNING AUTHORITY**  
 \*Subject to the fulfillment of conditions stipulated in the permit (Sl. No.1 to 8)

### ROAD PORTION AREA DETAILS

Road Name	Length (m)		Width (m)	Area (m <sup>2</sup> )
	L1 (m)	L2 (m)		
I Main Road	147.20	147.10	6.10	897.62
II Main Road	104.60	103.35	6.10	634.25
First Cross Street	191.65	191.55	6.10	1168.76
Second Cross Street	214.75	213.95	6.10	1307.54
Third Cross Street	201.15	200.65	6.10	1225.49
<b>Total</b>				<b>5233.66</b>

## LAYOUT PLAN

(Scale - 1:100)

ALL DIMENSIONS ARE IN METER

### EXTENT DETAILS

R.S.No.	EXTENT			Area (m <sup>2</sup> )
	H	A	Ca	
5/8Apt.	00	18	50	2003
6/1.	00	08	00	800
6/2.	02	64	00	26247
<b>Total</b>	<b>02</b>	<b>90</b>	<b>50</b>	<b>29050</b>

### OSR DETAILS

Plot Number	No.	Each Area (m <sup>2</sup> )	Area (m <sup>2</sup> )
73	1	145.49	145.49
74 to 76	3	167.44	502.32
103	1	242.00	242.00
104	1	113.80	113.80
<b>Total</b>	<b>6</b>		<b>1003.61</b>

### TRANSFORMER AREA DETAILS

Transformer Area (m <sup>2</sup> )	63.50
------------------------------------	-------

Total No. of Plots	141
No. of Plot Sold	51
No. of Plots Unsold	84
No. of OSR Plots	6

Approving Authority

*V. L. R. Uma*

**Er. A. DAYANITHY**  
 M.Tech., MIE., MCI.,  
 Registered Structural Engineer Grade-II  
 Reg.No. 3-899/PALIC/SE/2016.  
 14-58, MG Flat,  
 Sudhanthira Ponvizha Nagar,  
 Puducherry - 11.

Owner

Engineer