

# PLAN SHOWS THE LAYOUT IN THE NAME OF " ANNAPOORANI NAGAR" AT R.S.No. 66/10 pt, MADUKARAI REVENUE VILLAGE, NETTAPAKKAM COMMUNE PANCHAYAT, PUDUCHERRY.

IN-PRINCIPLE LAYOUT FRAME WORK APPROVAL ISSUED VIDE  
 NO. 1288 / 11395 / PPA / Z (N.C.P.) DATED  
 / Layout / IP-APP / 2021  
 03/03/2024  
 MEMBER SECRETARY  
 PUDUCHERRY PLANNING AUTHORITY  
 \*Subject to the fulfilment of conditions  
 Stipulated in the permit (Sl. No.1 to 8 )

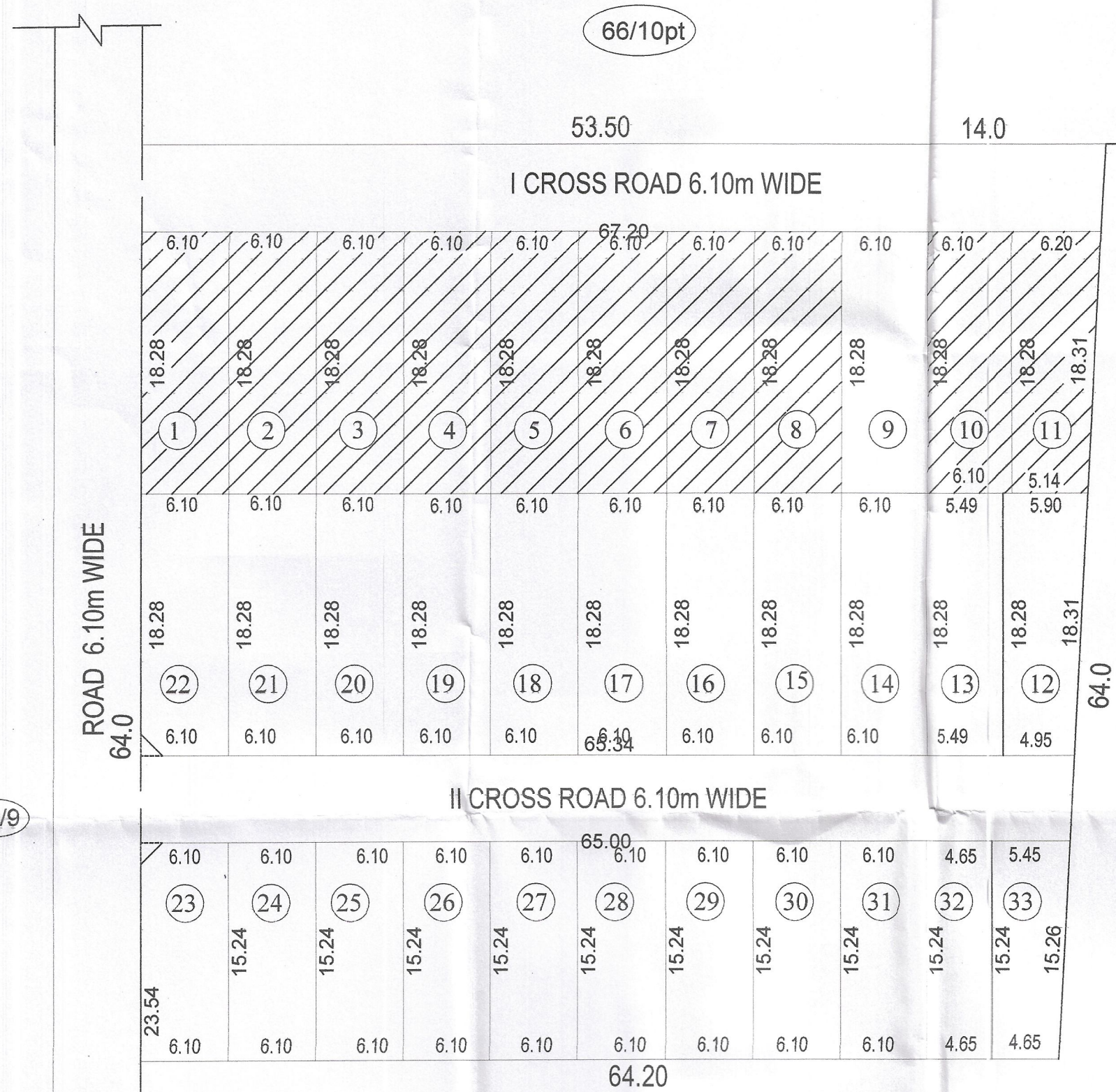

### UNSOLD PLOTS AREA

| Plot Number  | No.       | Area   | Area (m <sup>2</sup> ) |
|--------------|-----------|--------|------------------------|
| 9            | 1         | 111.52 | 111.52                 |
| 12           | 1         | 99.27  | 99.27                  |
| 13           | 1         | 100.35 | 100.35                 |
| 14 to 22     | 9         | 111.52 | 1003.68                |
| 23 to 31     | 9         | 92.94  | 836.46                 |
| 32           | 1         | 70.86  | 70.86                  |
| 33           | 1         | 77.01  | 77.01                  |
| <b>Total</b> | <b>23</b> |        | <b>2299.15</b>         |

### SOLD PLOTS AREA

| Plot Number  | No.       | Area   | Area (m <sup>2</sup> ) |
|--------------|-----------|--------|------------------------|
| 1 to 8       | 8         | 111.52 | 892.16                 |
| 10           | 1         | 111.52 | 111.52                 |
| 11           | 1         | 103.80 | 103.80                 |
| <b>Total</b> | <b>10</b> |        | <b>1107.48</b>         |

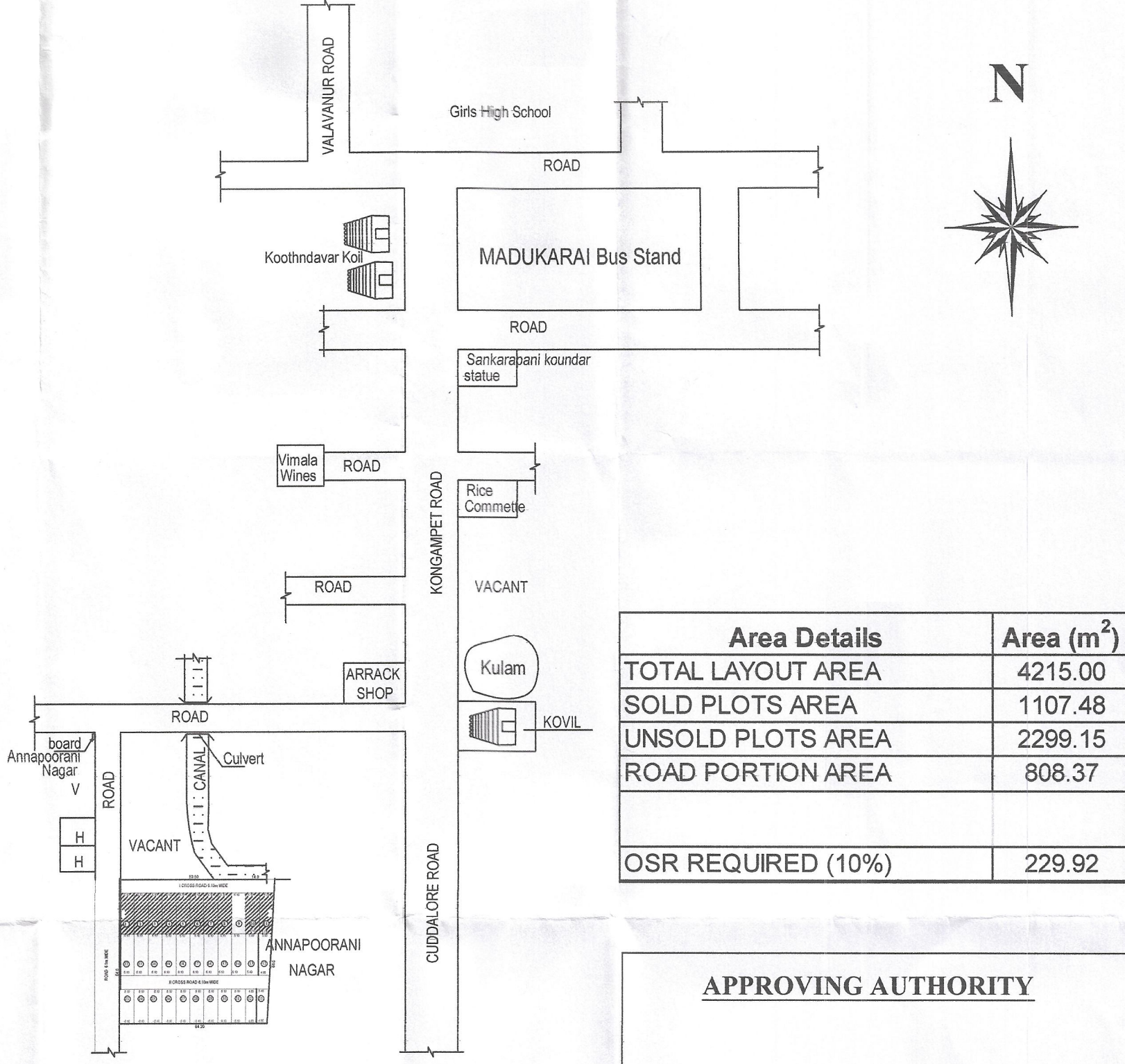

| Area Details       |  | Area (m <sup>2</sup> ) |
|--------------------|--|------------------------|
| TOTAL LAYOUT AREA  |  | 4215.00                |
| SOLD PLOTS AREA    |  | 1107.48                |
| UNSOLD PLOTS AREA  |  | 2299.15                |
| ROAD PORTION AREA  |  | 808.37                 |
| OSR REQUIRED (10%) |  | 229.92                 |

**SITE PLAN**  
Not To Scale

## LAYOUT PLAN (SCALE - 1:100)

ALL DIMENSIONS ARE IN METER

### EXTENT DETAILS

| R.S.No. | EXTENT |    |    | Area (m <sup>2</sup> ) |
|---------|--------|----|----|------------------------|
|         | H      | A  | Ca |                        |
| 66/10pt | 0      | 42 | 15 | 4215                   |

### ROAD PORTION AREA DETAILS

| Road Name           | Length (m) |        | Width (m) | Area (m <sup>2</sup> ) |
|---------------------|------------|--------|-----------|------------------------|
|                     | L1 (m)     | L2 (m) |           |                        |
| First Cross Street  | 67.50      | 67.20  | 6.10      | 410.84                 |
| Second Cross Street | 65.34      | 65.00  | 6.10      | 397.54                 |
| <b>Total</b>        |            |        |           | <b>308.37</b>          |

|                     |       |
|---------------------|-------|
| Total No. of Plots  | 33    |
| No. of Plots Sold   | 10    |
| No. of Plots Unsold | 23    |
| Percentage Sold %   | 30.30 |
| OSR                 | 10%   |

**LEGEND**

|                  |          |
|------------------|----------|
| SITE BOUNDARY    | [Symbol] |
| UNSOLD PLOTS     | [Symbol] |
| SOLD PLOTS       | [Symbol] |
| ROAD             | [Symbol] |
| F- LINE          | [Symbol] |
| TRANSFORMER YARD | [Symbol] |

J. Anandaraman

OWNER

### APPROVING AUTHORITY

*[Signature]*

**Er. A. DAYANITHY**  
 M.Tech., MIE., MCI.,  
 Registered Structural Engineer  
 H-56, MIG Flat,  
 Sudhanthira Ponvizha Nagar,  
 Puducherry - 11. **ENGINEER**