

Plan Showing The Sri Visalatchi Nagar Layout , R.S.No.29/2, 29/3,29/5, , Villianoor Revenue Village, Villianoor Commune, Puducherry.

Approving Authority :-

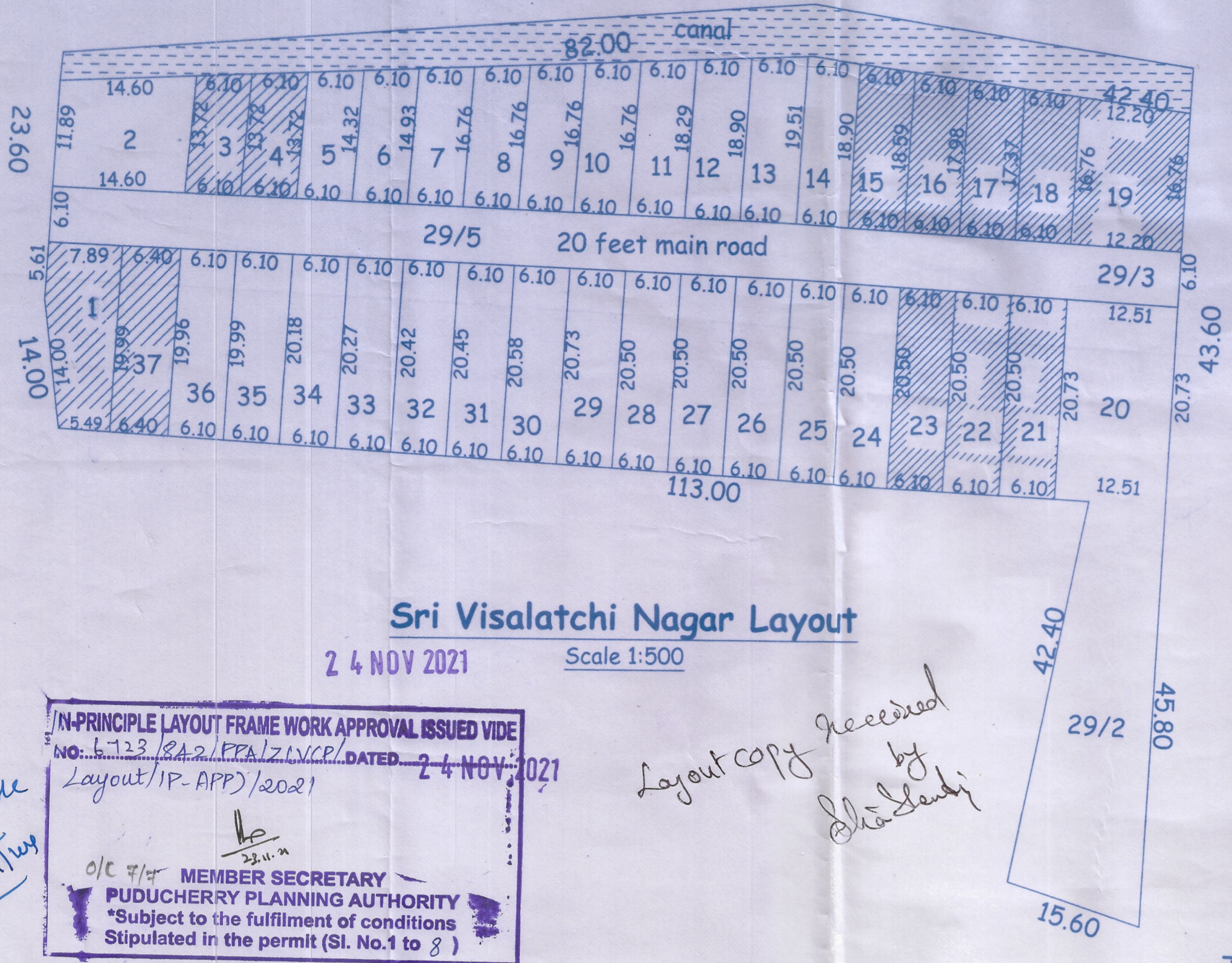

Sri Visalatchi Nagar Layout
24 NOV 2021
Scale 1:500

IN-PRINCIPLE LAYOUT FRAME WORK APPROVAL ISSUED VIDE
NO. L-123/842/PPA/LIC/RA/2020 DATED 24 NOV 2021
Layout/IP-APP/2021

o/c 7/4
MEMBER SECRETARY
PUDUCHERRY PLANNING AUTHORITY
*Subject to the fulfilment of conditions
Stipulated in the permit (Sl. No.1 to 8)

Layout copy received by Shri Sanki

Sold Plot Details		
sl no	Plot Nos	Sqm
1	1	131.86
2	3	83.69
3	4	83.69
4	15	114.31
5	16	111.51
6	17	107.79
7	18	104.07
8	19	204.47
9	21	125.05
10	22	125.05
11	23	125.05
12	37	127.81
Total		1444.35

UnSold Plot Details					
sl no	Plot Nos	Sqm	sl no	Plot Nos	Sqm
1	2	186.88	16	27	125.05
2	5	85.52	17	28	125.05
3	6	89.18	18	29	125.72
4	7	96.62	19	30	125.97
5	8	102.24	20	31	125.11
6	9	102.24	21	32	124.62
7	10	102.24	22	33	124.07
8	11	106.87	23	34	123.34
9	12	113.40	24	35	122.49
10	13	117.12	25	36	121.82
11	14	117.12	Total		1243.24
12	20	759.33			
13	24	125.05			
14	25	125.05			
15	26	125.05			
Total		2353.91			

Road Area		
Length	Bredth	Total
124.40	6.10	758.50
Total		758.50

Area Details	
Total Layout Area	- 5800.00
Sold Plot Area	- 1444.35 sqm
Unsold Plot Area	- 3597.15 sqm
Road area 29/3, 29/5	- 758.50 sqm
OSR Proposed	- NIL
OSR Required 10%	- 359.71 sqm

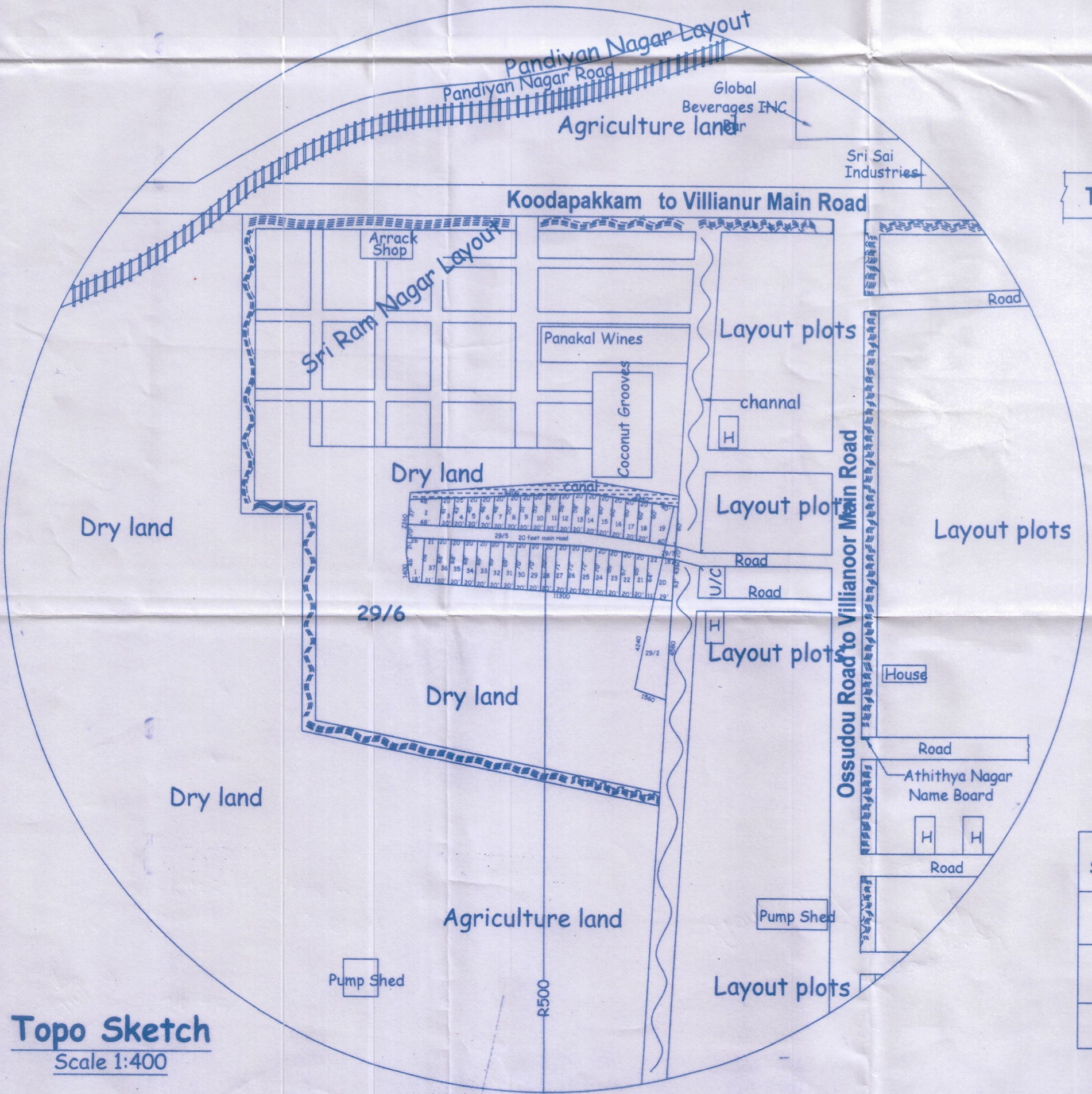

Topo Sketch
Scale 1:400

Villupuram - Pondy NH Road

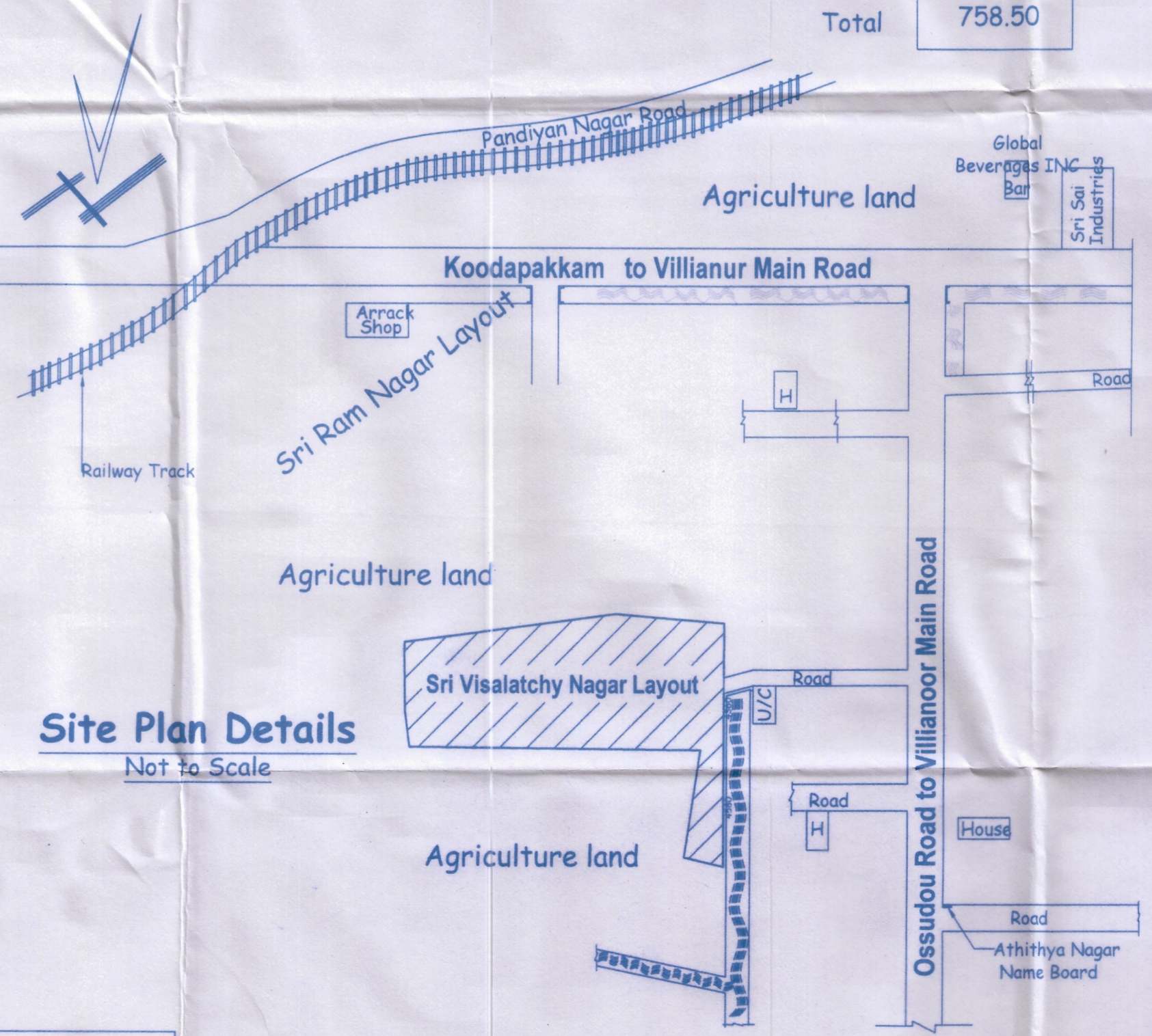

Site Plan Details
Not to Scale

sln	Description	Nos
1	Sold Plots	12
2	Un Sold Plots	25
Total Plots		37

R.S No	Total Extent
29/5	5050 sqm
29/2	500 sqm
29/3	250 sqm
Total	5800 sqm

- Sold Plots
- Un Sold Plots
- Road

All Dimensions are in cm (Unless otherwise mentioned) Date: 10.11.2020

Shri Sanki
Owner

Ambalavanan

K. AMBALAVANAN, M.Arch., A.I.I.A.
Reg No. 3-1098/PPA/LIC/RA/2020
NEO DESIGN ARCHITECTS
No.159/B, Fourth Cross St, D.R. Nagar,
Kosapalayam (Po), Puducherry - 605 013.
Cell: 9442129271, 6379645967

Engineer



cell no: 942311899 off:2204503
9442068919